

SCRAP RECOVERY GROUPS

OPTIMAL REUSE OF PASTA TRIMMINGS



TOTAL RECOVERY OF PRODUCTION SCRAP



“REC”, FRESH SCRAP RECOVERY: CLEVER AND FUNCTIONING

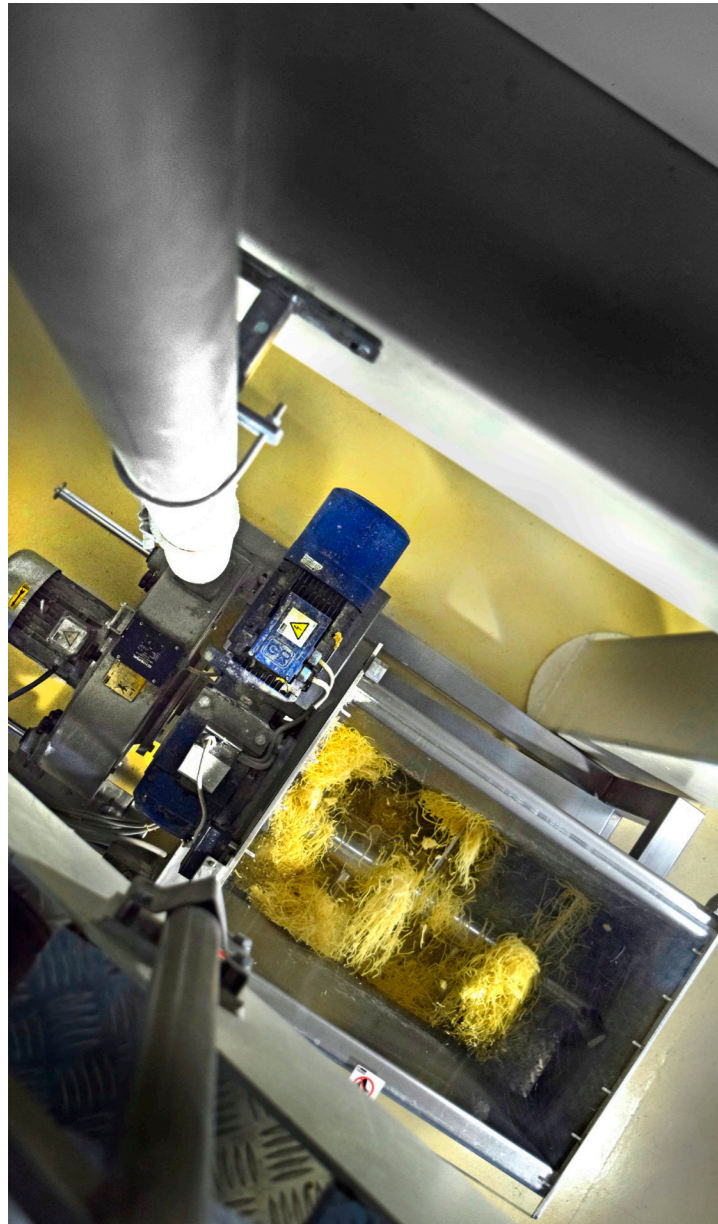

The request from pasta making factories

More and more pasta factories, any size, feel the need to correctly recover the trimmings coming from shape changeover, dough cuttings, production stops, etc. Raw material cost, constantly increasing nowadays, requires a clever and functioning scrap recovery.

The solution proposed by Storci

We offer a complete series of recovery systems, ranging from the simplest to the more technologically advanced, that allows to find always the right product for each system. It is necessary a simple equipment to obtain such a small scrap to be easily rehydrated. We have created scrap recovery groups by installing the new basket system on all models, forcing the scrap to pass through holes (with predetermined diameters), apt to adjust the dimension of the scrap crumb that is directed to the re-kneading process.

Models

EASY REC C/ALL, manually loaded for small/medium production; REC 500 C/A/I for medium production and large dimensions scrap, REC 1000 (REC 1000 C/A/I, REC 1001 C/A/I, REC 1002 C/A/I) and REC 2000/D AUT for large production, for a volumetric or gravimetric dosing also from collecting tanks.



WHAT ARE THE ADVANTAGES?

- ▶ MAXIMUM FUNCTIONALITY
- ▶ CLEVER RECOVERY
- ▶ TAILOR-MADE SOLUTIONS
- ▶ NO WASTE

ECONOMIC RETURN

BREAKEVEN POINT: function of the quantity of recovered scrap (hundred kilograms per week)

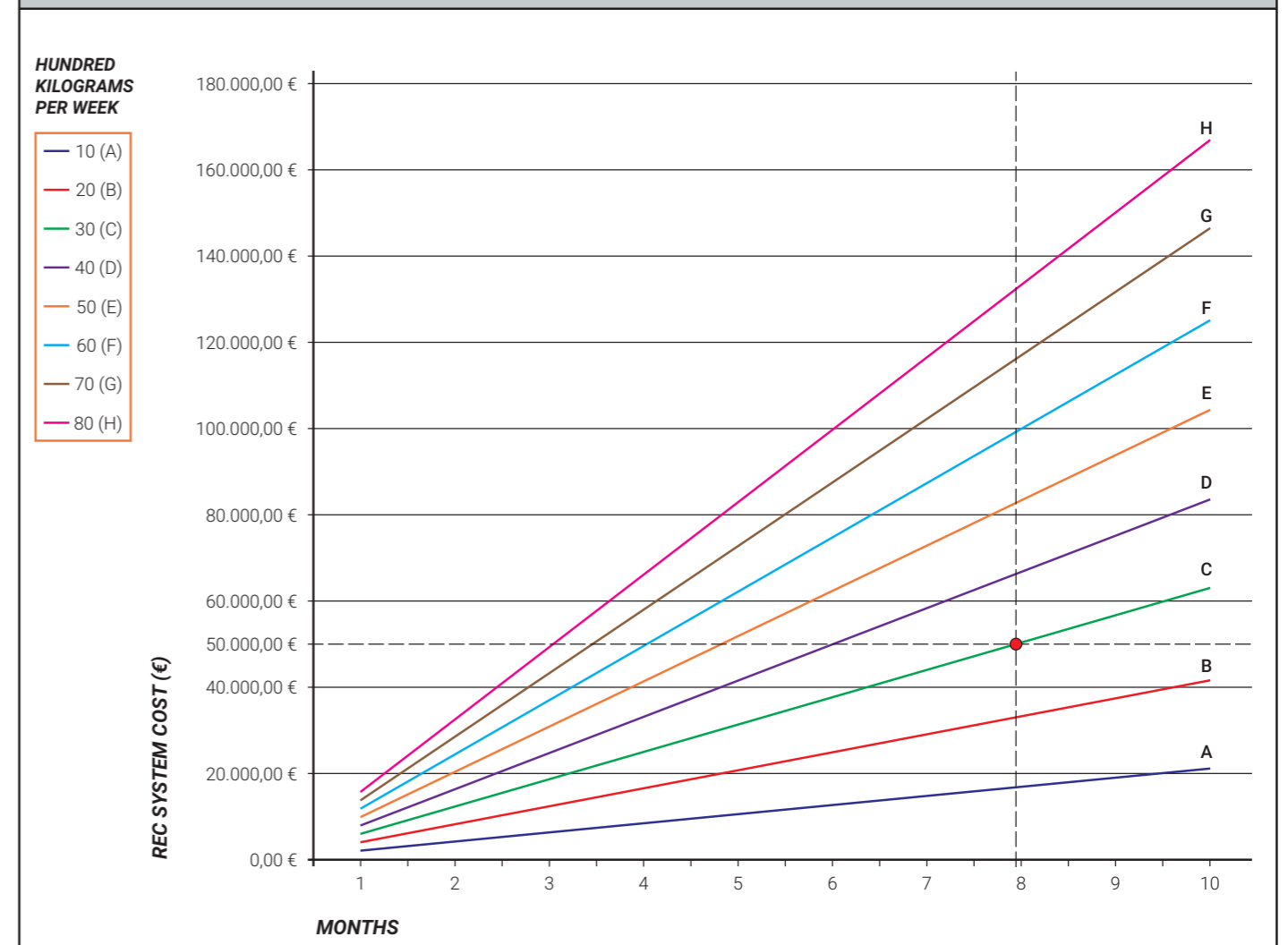

Perfect solutions for any need

Thanks to Storci's scrap recovery systems, not only can you find the perfect machine for your own production needs but also for your financial ones. Our Company can supply the solution that can meet your needs, by our technicians' consultancy and professionalism, guaranteeing the return on investment in a short time. Contrary to most systems on sale nowadays that take very long, the return on investment of Storci's REC is estimated in a few months, varying according to the quantity of scrap reused.

The graphic above shown represents the breakeven point of the initial investment of the Customer: depending on the

cost of the REC and the quantity of scrap to be recovered per week, the time of the investment return can be easily deduced.

E.G.:

If your initial investment amounts to 50.000 Euros and your scrap recovery is 3000 kgs of scrap per week, the balance can be reached in less than 8 months. Increasing the capacity of scrap recovery can reduce the time of the investment return.

GENERAL FEATURES

All scrap recovery systems offered by Storci are created to recover fresh trimmings of pasta with a humidity of 25-30%, not wet on the surface. They are made of stainless steel and consist of a feeding crumbling tank, unloading into the shredder - directly or by means of Damper system - and of a hopper for loading the fresh product to manually or automatically feed the tank. The shaft of the tank has sharp paddles with blind conical hole and is pressed fit (with no bolts), to prevent stagnation of the product, thus allowing an easy cleaning.

C/ALL AND C/A/I: THE SHREDDING SYSTEM OF THE SCRAP

Storci fans-shredders are equipped with a basket forcing the trimmings to pass through holes, which have pre-determined diameter, so that a well-shred product is obtained.

There are two types as follows:

- C/ALL: it is equipped with a standard nickel aluminium basket
- C/A/I: top of the line, equipped with an openable basket, made of thick stainless steel (sound-proof), linear sliding on axial tracks for a better and easier cleaning.



Detail of C/A/I openable shredder

DAMPER: OPTIMISATION OF THE SCRAP DOSING SYSTEM

This system that is present in the superior quality recovery groups, consists of a spiral screw or a conveyor belt placed between the tank and the shredder. It allows to feed the latter one with a constant dosing, continuously monitoring the quantity of scrap coming from the tank. This way you can limit the maximum capacity.

The belt or the screw have a reversible motion that allows feeding the shredder as well as diverting a non-suitable product.

The graphic here shown, has been obtained comparing several scrap recovery systems on the market with Damper technology proposed by Storci.

This clearly shows that Storci is the only Company able to supply recovery groups whose capacity of exiting scrap is constant. In other systems, on the contrary, this capacity may vary. Consequently, the mixing in the kneading basin

- where the trimmings are re-entered - does not have constant quality characteristics.

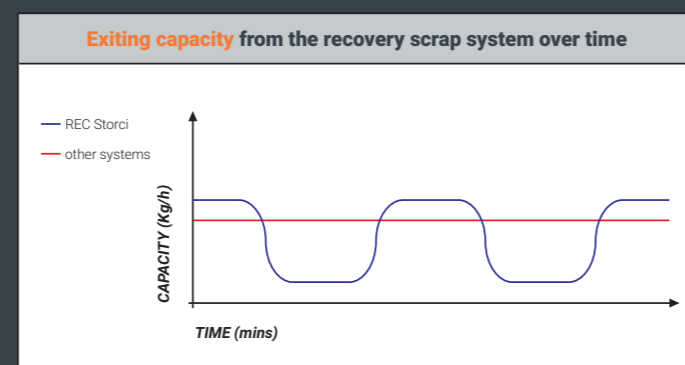

OPTIONAL AND COMPLEMENTARY ITEMS

All REC Models can be combined with the following optional elements:

- **Piping, joints, wide radius curve and settlement cyclone.** With or without airlock valve, to guarantee the most efficiency of the group.

- **Manual or automatic diverting valves for multiple feedings.** Opportunities to feed one or more presses either with manual connection and automatic diverting valves.
- **To be combined with a sound proof booth.** For the reduction of noise pollution.

STORCI'S MODELS



EASY REC 150: SCRAP RECOVERY STANDARD GROUP

Main technical features

- tank capacity: 30 litres
- C/ALL shredder
- indicative operating capacity: 50-150 kg/h approximately
- it is suitable for small/medium lumps
- inexpensive: the best quality/price ratio

Model	Power (kW)	Piping lenght (mt)	Maximum shredding capacity (Kg/H)	Dimensions (LxWxH)
150 C/ALL	4.5*	15	50-150	1021x806x1616

* (3kW each fan-shredder)

NotaBene: data shown are not binding, just indicative as subject to variability of the products and plants where the groups will be installed.

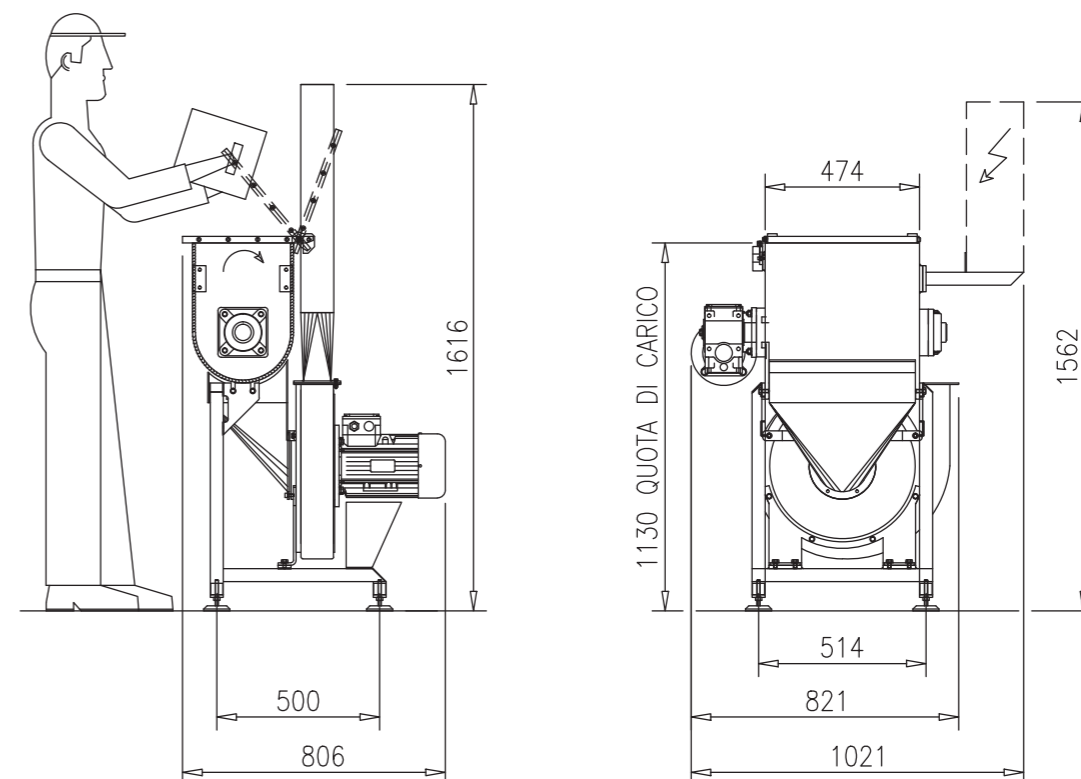

REC 500 C/A/I: SCRAP RECOVERY GROUP WITH OPENABLE SHREDDER



Main technical features

- tank capacity: 130 litres
- C/A/I shredder
- indicative operating capacity: 300-500 kg/h approximately
- it is suitable for small/medium lumps

Model	Power (kW)	Piping length (mt)	Maximum shredding capacity (Kg/H)	Dimensions (LxWxH)
500 C/A/I 4.0	9.5	20	300-500 (*)	1906x1541x2066
500 C/A/I 7.5	13	28	300-500 (*)	1906x1541x2066
500 C/A/I 15	21.5	40	300-500 (*)	1906x1541x2066

NotaBene: data shown are not binding, just indicative as subject to variability of the products and plants where the groups will be installed.
(*) for products not wet on the surface, with a maximum humidity of 30%, homogeneously distributed.

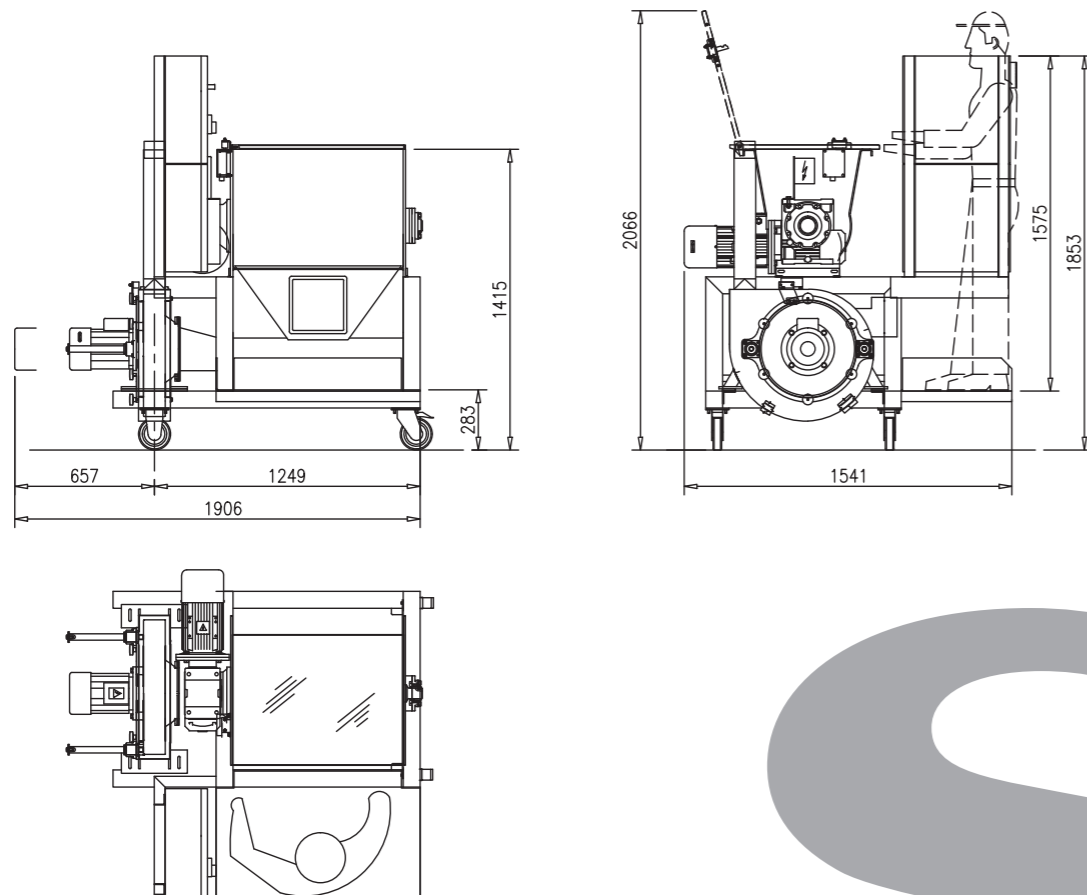

REC 1000 C/A/I: SCRAP RECOVERY GROUP WITH OPENABLE SHREDDER AND HOMOGENIZER



Main technical features

- tank capacity: 130 litres
- C/A/I shredder
- DAMPER system
- indicative operating capacity: 300-500 kg/h
- it is suitable for small/medium lumps

Model	Power (kW)	Piping length (mt)	Maximum shredding capacity (kg/h)	Dimensions (LxWxH)
1000 C/A/I 4.0	10	20	300-500 (*)	3237x1541x1473
1000 C/A/I 7.5	13.5	28	300-500 (*)	3237x1541x1473
1000 C/A/I 15	21	40	300-500 (*)	3237x1541x1473

NotaBene: data shown are not binding, just indicative as subject to variability of the products and plants where the groups will be installed.
(*) for products not wet on the surface, with a maximum humidity of 30%, homogeneously distributed.

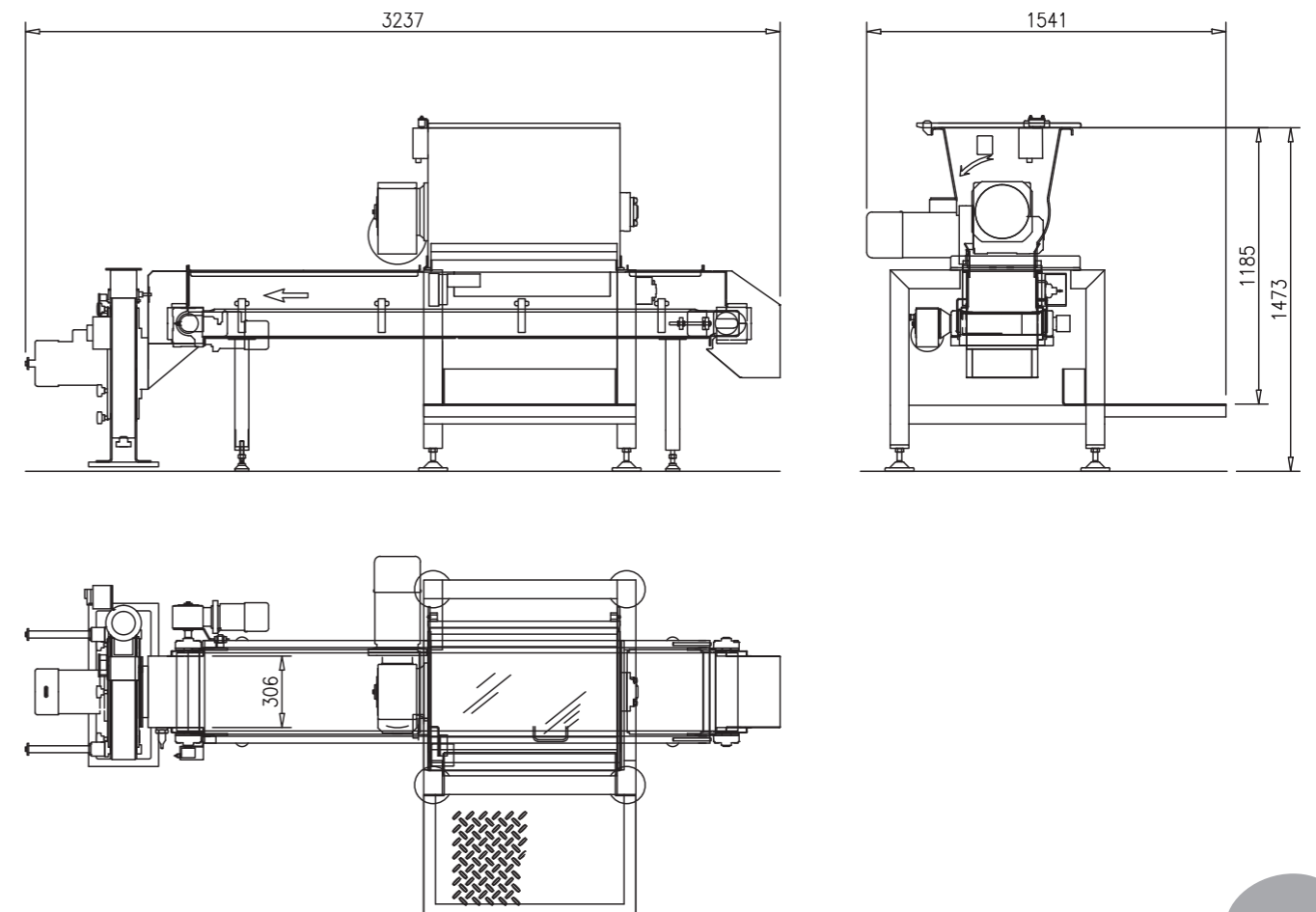

REC 1001 C/A/I:

REC GROUP WITH TANKS LOADING (O LIFTING) AND OVERTURNING



Main technical features

- tank capacity: 130 litres (double shaft)
- C/A/I shredder
- DAMPER system
- indicative operating capacity: 300-500 kg/h
- it is suitable for medium/large lumps
- perfect for small/medium kneading tanks
- system with lifting/overturning device for tanks (95 litres) containing fresh product



Model	Power (kW)	Piping length (mt)	Maximum shredding capacity (Kg/H)	Dimensions (LxWxH)
1001 C/A/I 4.0	11.5	20	300-500 (*)	1550x2010x2225
1001 C/A/I 7.5	15	28	300-500 (*)	1550x2010x2225
1001 C/A/I 15	22.5	40	300-500 (*)	1550x2010x2225

Dimensions and technical data are supplied without any further obligation on our part. Storci S.p.A. reserve the right to modify them without notice.
 NotaBene: data shown are not binding, just indicative as subject to variability of the products and plants where the groups will be installed.
 (*) for products not wet on the surface, with a maximum humidity of 30%, homogeneously distributed.

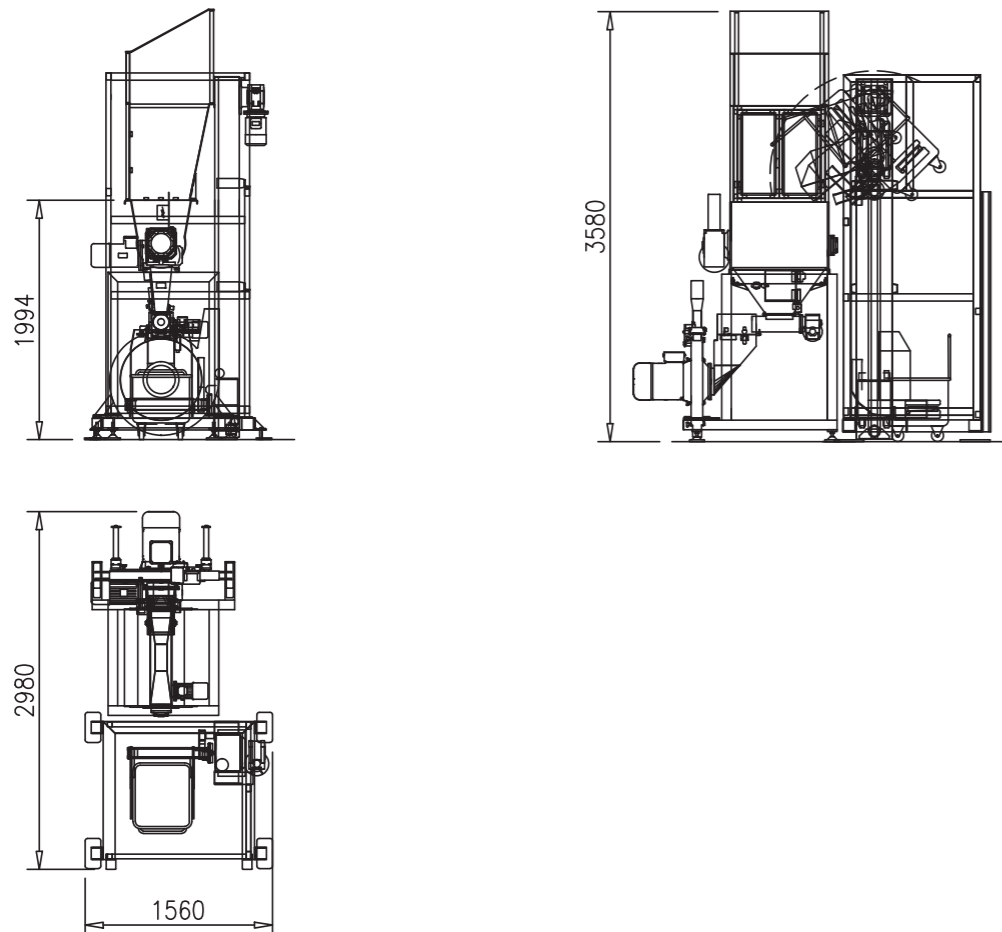

REC 1002 C/A/I:

REC GROUP WITH TANKS LOADING (O LIFTING) AND OVERTURNING



Main technical features

- tank capacity: 130 litres (with double shaft)
- C/A/I shredder
- DAMPER system
- indicative operating capacity: 600-700 kg/h approximately
- it is suitable for medium/large lumps
- perfect for all kneading tanks
- loading system that is automated by elevator for the tanks containing the scrap.

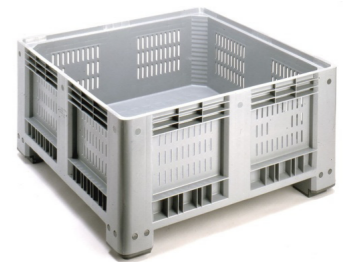

Model	Power (kW)	Piping length (mt)	Maximum shredding capacity (Kg/H)	Dimensions (LxWxH)
1002 C/A/I 4.0	26.5	20	600-700 (*)	2700x5800x4250
1002 C/A/I 7.5	30	28	600-700 (*)	2700x5800x4250
1002 C/A/I 15	37.5	40	600-700 (*)	2700x5800x4250

Dimensions and technical data are supplied without any further obligation on our part. Storci S.p.A. reserve the right to modify them without notice.
 NotaBene: data shown are not binding, just indicative as subject to variability of the products and plants where the groups will be installed.
 (*) for products not wet on the surface, with a maximum humidity of 30%, homogeneously distributed.

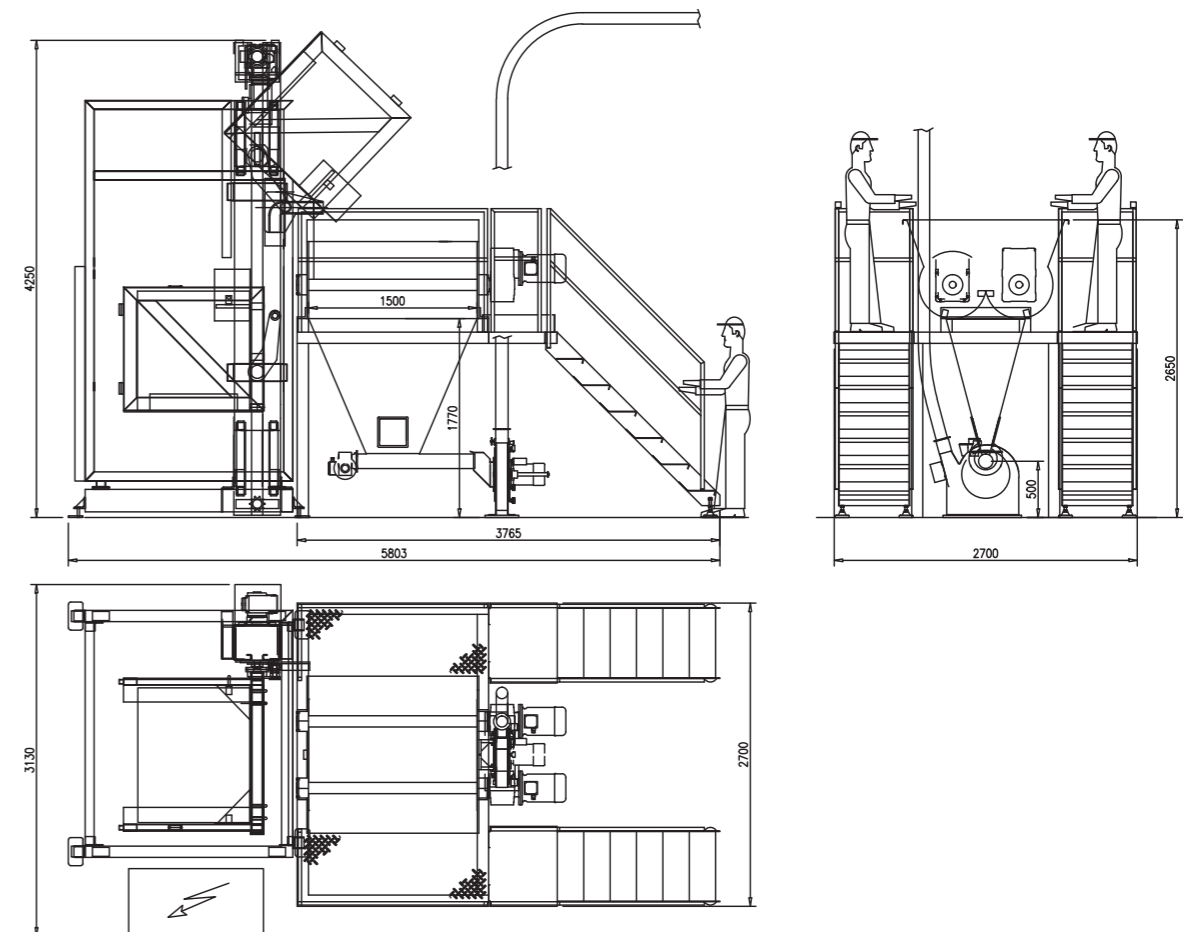

REC 2000/D AUT:

SCRAP RECOVERY GROUP REC 1002 WITH
SCRAP DRYING PROCESS

Main technical features

- tank capacity: 640 litres (with double shaft)
- C/A/I shredder
- DAMPER system
- indicative operating capacity: 600-700 kg/h approximately
- it is suitable for medium/large lumps
- perfect for all kneading tanks
- loading system that is automated by elevator for the tanks containing the scrap
- thermal treatment system: the shredded scrap is subsequently dried; this way, it can be reentered in the dry kneading system, instead of the fresh system, thus guaranteeing a higher flexibility of usage during the various production phases.



Shaft of the tank



Loading box

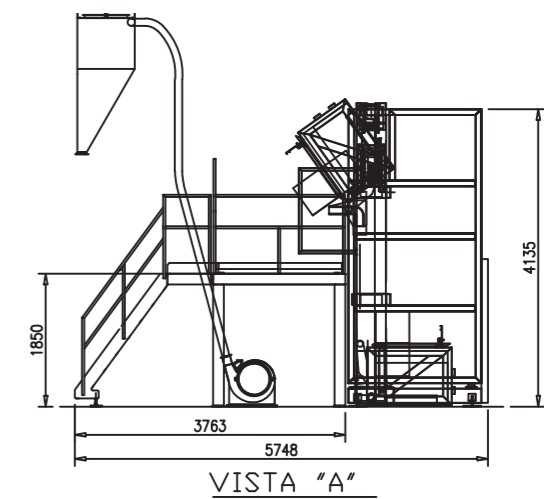
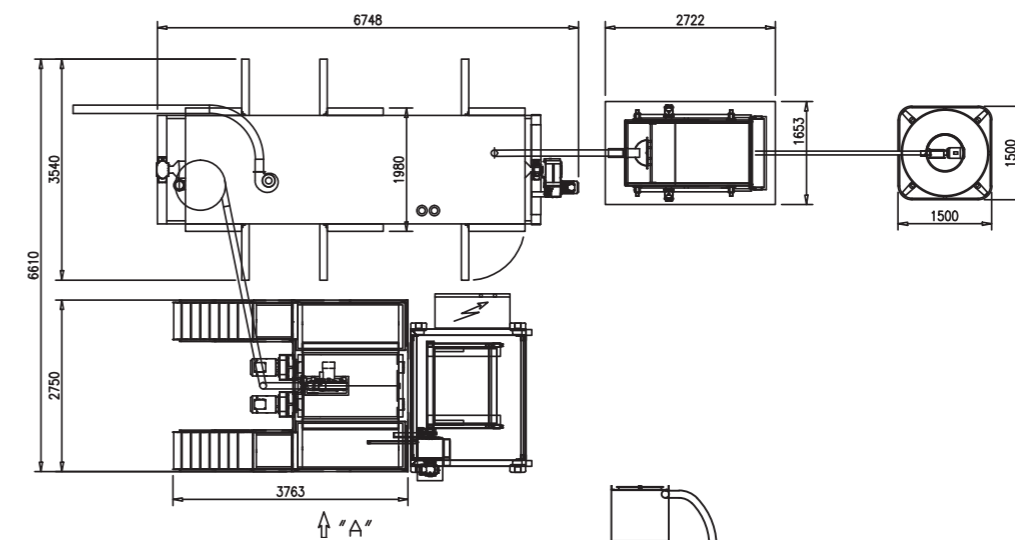
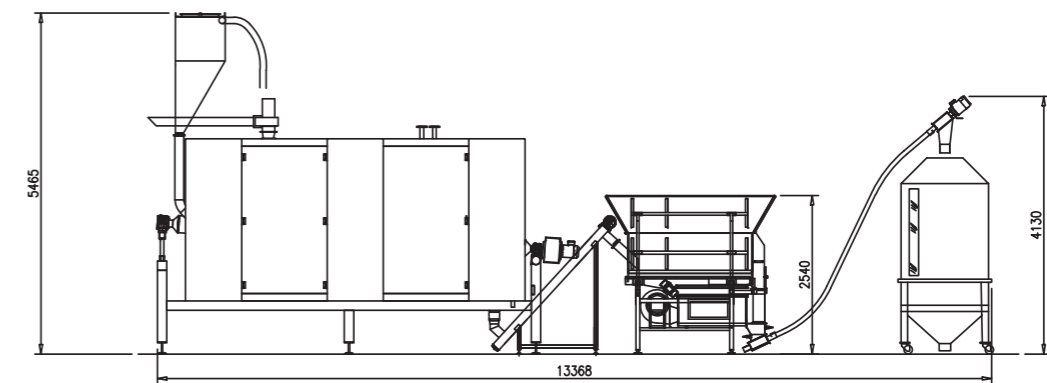

VISTA "A"

Model	Power (kW)	Maximum shredding capacity (Kg/H)	Dimensions (LxWxH)
2000/D AUT	39	600-700 (*)	2700x5800x4250

Dimensions and technical data are supplied without any further obligation on our part. Storci S.p.A. reserve the right to modify them without notice.
NotaBene: data shown are not binding, just indicative as subject to variability of the products and plants where the groups will be installed.
(*) for products not wet on the surface, with a maximum humidity of 30%, homogeneously distributed.

STORCI spa

Via Lemignano, 43044 Collecchio (PR) ITALY

CONTATTI



+39 0521 543611



+39 0521 543621



sales-storci@storci.com



www.storci.com



www.instantpasta.info



Storci International Website